

USE
CLASS A VARIANCE

AREA
CLASS B VARIANCE

SUP
SPECIAL USE PERMIT

Date: 3-4-21

Appeal No. 2263

An application is hereby made to the Zoning Board of Appeals pursuant to the City of Plattsburgh Zoning Ordinance for a variance to allow the property use as herein described.

Applicant: Gabe Girard representative for Come Learn with me

Applicant's Address: 18 Jerry Dr.
Plattsburgh, NY 12901

Telephone No.: 518-593-8980

Parcel Identification: 207.19-3-8

Location of Request: 61 Brinkerhoff St.

Property Owner: Come Learn with me LLC

Request Description: Convert the 1st level office space to an
apartment. No remodeling Required.

Zoning District: RH Assessment states: G2-R1 low density

Section Appealed: _____

Previous Appeal: No _____ Date _____

Identify Applicant's Right to Apply for Variance

Ownership: representing long Term Lease: _____ Contract To Purchase: _____

Other (Please Explain): My wife owns Come Learn with me and I
manage the property.

Applications for Zoning Variances must be accompanied by:
13 copies of existing and proposed site plan
13 copies of existing and proposed floor plan

The Zoning Board of Appeals may impose reasonable conditions and restrictions on the grant of area and use variances provided they are directly related to and incidental to the proposed use of the property. Such conditions shall be consistent with the spirit and intent of the zoning law, and shall be imposed for the purpose of minimizing any adverse impact such variance may have on the neighborhood or community.

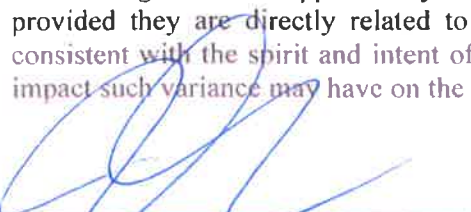
Signature (Owner/Applicant)
Melissa Pichalski
Print First and Last Name

Notary Public

LISA M. BEEBIE
Notary Public, State of New York
No. 01BE0395749
Qualified in Clinton County
Commission expires August 5, 2023

USE VARIANCE CRITERIA

No such use variance shall be granted by the zoning board of appeals without a showing by the applicant that applicable zoning regulations and restrictions have caused an "Unnecessary Hardship." In order to prove such unnecessary hardship the applicant shall demonstrate to the Zoning Board of Appeals that for each and every permitted use under the zoning regulations for the particular district where the property is located:

Please give a written response to the following criteria;

- (1) You must prove a lack of reasonable return. Please provide competent financial evidence which proves a lack of reasonable return.

We are not able to rent the bottom floor as an office offered at \$800 per month. There has been zero interest since advertised. We are able to rent the bottom floor as a 2 bedroom apt. for \$1300.00. There is demand for this location as an apartment; however, to date there is no interest in this space as an office rental.

- (2) Please demonstrate why your hardship is unique to your property and does not apply to a substantial portion of the neighborhood.

This building is set up as a 3 unit building in a residential area. Nothing would be altered to the building and it would actually provide less traffic on the street and to and from the building if converted to a 3rd apartment.

- (3) Please show that granting this use variance will not change the essential character of the neighborhood.

Absolutely nothing would change to the neighborhood and the building. In fact, fewer cars would be in and out of the area and fewer people would be in and out of the building.

- (4) Please demonstrate why the alleged hardship has not been self-created

We purchased this building, perhaps ignorantly assuming we would be able to utilize this building as 3 apartments. Three units would yield a reasonable amount for the owners' retirement. If they are unable to utilize this space as a 3 unit apartment building then they will face a financial hardship from this investment.

**Full Environmental Assessment Form
Part 1 - Project and Setting**

Instructions for Completing Part 1

Part 1 is to be completed by the applicant or project sponsor. Responses become part of the application for approval or funding, are subject to public review, and may be subject to further verification.

Complete Part 1 based on information currently available. If additional research or investigation would be needed to fully respond to any item, please answer as thoroughly as possible based on current information; indicate whether missing information does not exist, or is not reasonably available to the sponsor; and, when possible, generally describe work or studies which would be necessary to update or fully develop that information.

Applicants/sponsors must complete all items in Sections A & B. In Sections C, D & E, most items contain an initial question that must be answered either "Yes" or "No". If the answer to the initial question is "Yes", complete the sub-questions that follow. If the answer to the initial question is "No", proceed to the next question. Section F allows the project sponsor to identify and attach any additional information. Section G requires the name and signature of the applicant or project sponsor to verify that the information contained in Part 1 is accurate and complete.

A. Project and Applicant/Sponsor Information.

Name of Action or Project: <i>61 Brinkerhoff office to Apartment</i>		
Project Location (describe, and attach a general location map): <i>61 Brinkerhoff</i>		
Brief Description of Proposed Action (include purpose or need): <i>No remodeling required. Change of use requested. From office space to apartment.</i>		
Name of Applicant/Sponsor: <i>Gabe Girard</i>		Telephone: <i>518-593-8980</i>
Address: <i>18 Jerry Dr.</i>		E-Mail: <i>gabe-girard@hotmail.com</i>
City/PO: <i>Plattsburgh</i>	State: <i>N.Y.</i>	Zip Code: <i>12901</i>
Project Contact (if not same as sponsor; give name and title/role): <i>Same</i>		Telephone:
Address:		E-Mail:
City/PO:	State:	Zip Code:
Property Owner (if not same as sponsor): <i>Come Learn with me LLC</i>		Telephone: <i>518-569-9884</i>
Address: <i>21 New York Rd</i>		E-Mail: <i>-</i>
City/PO: <i>Plattsburgh</i>	State: <i>N.Y.</i>	Zip Code: <i>12901</i>

B. Government Approvals

B. Government Approvals, Funding, or Sponsorship. ("Funding" includes grants, loans, tax relief, and any other forms of financial assistance.)

Government Entity	If Yes: Identify Agency and Approval(s) Required	Application Date (Actual or projected)
a. City Council, Town Board, or Village Board of Trustees <input checked="" type="checkbox"/> Yes <input checked="" type="checkbox"/> No	Zoning	
b. City, Town or Village Planning Board or Commission <input type="checkbox"/> Yes <input checked="" type="checkbox"/> No		
c. City, Town or Village Zoning Board of Appeals <input checked="" type="checkbox"/> Yes <input type="checkbox"/> No	Zoning	
d. Other local agencies <input type="checkbox"/> Yes <input checked="" type="checkbox"/> No		
e. County agencies <input type="checkbox"/> Yes <input checked="" type="checkbox"/> No		
f. Regional agencies <input type="checkbox"/> Yes <input checked="" type="checkbox"/> No		
g. State agencies <input type="checkbox"/> Yes <input checked="" type="checkbox"/> No		
h. Federal agencies <input type="checkbox"/> Yes <input checked="" type="checkbox"/> No		
i. Coastal Resources.		
i. Is the project site within a Coastal Area, or the waterfront area of a Designated Inland Waterway?		<input type="checkbox"/> Yes <input checked="" type="checkbox"/> No
ii. Is the project site located in a community with an approved Local Waterfront Revitalization Program?		<input type="checkbox"/> Yes <input checked="" type="checkbox"/> No
iii. Is the project site within a Coastal Erosion Hazard Area?		<input type="checkbox"/> Yes <input checked="" type="checkbox"/> No

C. Planning and Zoning

C.1. Planning and zoning actions.

Will administrative or legislative adoption, or amendment of a plan, local law, ordinance, rule or regulation be the only approval(s) which must be granted to enable the proposed action to proceed? Yes No

- If Yes, complete sections C, F and G.
- If No, proceed to question C.2 and complete all remaining sections and questions in Part 1

C.2. Adopted land use plans.

a. Do any municipally- adopted (city, town, village or county) comprehensive land use plan(s) include the site where the proposed action would be located? Yes No
 If Yes, does the comprehensive plan include specific recommendations for the site where the proposed action would be located? Yes No

b. Is the site of the proposed action within any local or regional special planning district (for example: Greenway, Brownfield Opportunity Area (BOA); designated State or Federal heritage area; watershed management plan; or other?) Yes No
 If Yes, identify the plan(s):

c. Is the proposed action located wholly or partially within an area listed in an adopted municipal open space plan, or an adopted municipal farmland protection plan? Yes No
 If Yes, identify the plan(s):

C.3. Zoning

a. Is the site of the proposed action located in a municipality with an adopted zoning law or ordinance? Yes No
If Yes, what is the zoning classification(s) including any applicable overlay district?
not sure

b. Is the use permitted or allowed by a special or conditional use permit? Yes No

c. Is a zoning change requested as part of the proposed action? Yes No
If Yes,
i. What is the proposed new zoning for the site? apt vs. office

C.4. Existing community services.

a. In what school district is the project site located? Plattsburgh

b. What police or other public protection forces serve the project site?
Plattsburgh

c. Which fire protection and emergency medical services serve the project site?
Plattsburgh

d. What parks serve the project site?
TP not sure

D. Project Details

D.1. Proposed and Potential Development

a. What is the general nature of the proposed action (e.g., residential, industrial, commercial, recreational; if mixed, include all components)?
convert to residential Apt vs. office

b. a. Total acreage of the site of the proposed action? .2 acres
b. Total acreage to be physically disturbed? 0 acres
c. Total acreage (project site and any contiguous properties) owned or controlled by the applicant or project sponsor? 100.2 acres

c. Is the proposed action an expansion of an existing project or use? Yes No
i. If Yes, what is the approximate percentage of the proposed expansion and identify the units (e.g., acres, miles, housing units, square feet)? % Units:

d. Is the proposed action a subdivision, or does it include a subdivision? Yes No
If Yes,
i. Purpose or type of subdivision? (e.g., residential, industrial, commercial; if mixed, specify types)

ii. Is a cluster/conservation layout proposed? Yes No
iii. Number of lots proposed?
iv. Minimum and maximum proposed lot sizes? Minimum Maximum

e. Will the proposed action be constructed in multiple phases? Yes No
i. If No, anticipated period of construction. 0 months
ii. If Yes:
• Total number of phases anticipated 0
• Anticipated commencement date of phase 1 (including demolition) month year
• Anticipated completion date of final phase month year
• Generally describe connections or relationships among phases, including any contingencies where progress of one phase may determine timing or duration of future phases:
No changes or construction required.

f. Does the project include new residential uses? Yes No
 If Yes, show numbers of units proposed.

	One Family	Two Family	Three Family	Multiple Family (four or more)
Initial Phase		X		
At completion of all phases			X	

g. Does the proposed action include new non-residential construction (including expansions)? Yes No
 If Yes,
 i. Total number of structures _____
 ii. Dimensions (in feet) of largest proposed structure. _____ height, _____ width, and _____ length.
 iii. Approximate extent of building space to be heated or cooled: _____ square feet

h. Does the proposed action include construction or other activities that will result in the impoundment of any liquids, such as creation of a water supply, reservoir, pond, lake, waste lagoon or other storage? Yes No
 If Yes,
 i. Purpose of the impoundment: _____
 ii. If a water impoundment, the principal source of the water: Ground water Surface water streams Other specify: _____
 iii. If other than water, identify the type of impounded/contained liquids and their source. _____
 iv. Approximate size of the proposed impoundment. Volume: _____ million gallons; surface area: _____ acres
 v. Dimensions of the proposed dam or impounding structure: _____ height; _____ length
 vi. Construction method/materials for the proposed dam or impounding structure (e.g., earth fill, rock, wood, concrete): _____
 N/A

D.2. Project Operations

a. Does the proposed action include any excavation, mining, or dredging, during construction, operations, or both? (Not including general site preparation, grading or installation of utilities or foundations where all excavated materials will remain onsite) Yes No
 If Yes:
 i. What is the purpose of the excavation or dredging? _____
 ii. How much material (including rock, earth, sediments, etc.) is proposed to be removed from the site?
 • Volume (specify tons or cubic yards): _____
 • Over what duration of time? _____
 iii. Describe nature and characteristics of materials to be excavated or dredged, and plans to use, manage or dispose of them.

 iv. Will there be onsite dewatering or processing of excavated materials? Yes No
 If yes, describe. _____
 v. What is the total area to be dredged or excavated? _____ acres
 vi. What is the maximum area to be worked at any one time? _____ acres
 vii. What would be the maximum depth of excavation or dredging? _____ feet
 viii. Will the excavation require blasting? Yes No
 ix. Summarize site reclamation goals and plan: _____

b. Would the proposed action cause or result in alteration of, increase or decrease in size of, or encroachment into any existing wetland, waterbody, shoreline, beach or adjacent area? Yes No
 If Yes:
 i. Identify the wetland or waterbody which would be affected (by name, water index number, wetland map number or geographic description). _____

ii. Describe how the proposed action would affect that waterbody or wetland, e.g. excavation, fill, placement of structures, or alteration of channels, banks and shorelines. Indicate extent of activities, alterations and additions in square feet or acres:

not affected

iii. Will the proposed action cause or result in disturbance to bottom sediments? Yes No

If Yes, describe:

iv. Will the proposed action cause or result in the destruction or removal of aquatic vegetation? Yes No

If Yes:

- acres of aquatic vegetation proposed to be removed: _____
- expected acreage of aquatic vegetation remaining after project completion: _____
- purpose of proposed removal (e.g. beach clearing, invasive species control, boat access): _____
- proposed method of plant removal: _____
- if chemical/herbicide treatment will be used, specify product(s): _____

v. Describe any proposed reclamation/mitigation following disturbance: _____

c. Will the proposed action use, or create a new demand for water? Yes No

If Yes:

i. Total anticipated water usage/demand per day: _____ gallons/day

ii. Will the proposed action obtain water from an existing public water supply? Yes No

If Yes:

- Name of district or service area: _____
- Does the existing public water supply have capacity to serve the proposal? Yes No
- Is the project site in the existing district? Yes No
- Is expansion of the district needed? Yes No
- Do existing lines serve the project site? Yes No

iii. Will line extension within an existing district be necessary to supply the project? Yes No

If Yes:

• Describe extensions or capacity expansions proposed to serve this project: _____

• Source(s) of supply for the district: _____

iv. Is a new water supply district or service area proposed to be formed to serve the project site? Yes No

If Yes:

- Applicant/sponsor for new district: _____
- Date application submitted or anticipated: _____
- Proposed source(s) of supply for new district: _____

v. If a public water supply will not be used, describe plans to provide water supply for the project: _____

vi. If water supply will be from wells (public or private), what is the maximum pumping capacity: _____ gallons/minute.

d. Will the proposed action generate liquid wastes? Yes No

If Yes:

i. Total anticipated liquid waste generation per day: _____ gallons/day

ii. Nature of liquid wastes to be generated (e.g., sanitary wastewater, industrial; if combination, describe all components and approximate volumes or proportions of each): _____

iii. Will the proposed action use any existing public wastewater treatment facilities? Yes No

If Yes:

- Name of wastewater treatment plant to be used: _____
- Name of district: _____
- Does the existing wastewater treatment plant have capacity to serve the project? Yes No
- Is the project site in the existing district? Yes No
- Is expansion of the district needed? Yes No

• Do existing sewer lines serve the project site? Yes No
 • Will a line extension within an existing district be necessary to serve the project? Yes No
 If Yes:

- Describe extensions or capacity expansions proposed to serve this project: _____

iv. Will a new wastewater (sewage) treatment district be formed to serve the project site? Yes No
 If Yes:

- Applicant/sponsor for new district: _____
- Date application submitted or anticipated: _____
- What is the receiving water for the wastewater discharge? _____

v. If public facilities will not be used, describe plans to provide wastewater treatment for the project, including specifying proposed receiving water (name and classification if surface discharge or describe subsurface disposal plans):

vi. Describe any plans or designs to capture, recycle or reuse liquid waste: _____

e. Will the proposed action disturb more than one acre and create stormwater runoff, either from new point sources (i.e. ditches, pipes, swales, curbs, gutters or other concentrated flows of stormwater) or non-point source (i.e. sheet flow) during construction or post construction? Yes No
 If Yes:

- How much impervious surface will the project create in relation to total size of project parcel?
 _____ Square feet or _____ acres (impervious surface)
 _____ Square feet or _____ acres (parcel size)
- Describe types of new point sources. _____
- Where will the stormwater runoff be directed (i.e. on-site stormwater management facility/structures, adjacent properties, groundwater, on-site surface water or off-site surface waters)?

 - If to surface waters, identify receiving water bodies or wetlands: _____

Will stormwater runoff flow to adjacent properties? Yes No
 iv. Does the proposed plan minimize impervious surfaces, use pervious materials or collect and re-use stormwater? Yes No

f. Does the proposed action include, or will it use on-site, one or more sources of air emissions, including fuel combustion, waste incineration, or other processes or operations? Yes No
 If Yes, identify:

- Mobile sources during project operations (e.g., heavy equipment, fleet or delivery vehicles) _____
- Stationary sources during construction (e.g., power generation, structural heating, batch plant, crushers) _____
- Stationary sources during operations (e.g., process emissions, large boilers, electric generation) _____

g. Will any air emission sources named in D.2.f (above), require a NY State Air Registration, Air Facility Permit, or Federal Clean Air Act Title IV or Title V Permit? Yes No
 If Yes:

- Is the project site located in an Air quality non-attainment area? (Area routinely or periodically fails to meet ambient air quality standards for all or some parts of the year) Yes No
- In addition to emissions as calculated in the application, the project will generate:
 - _____ Tons/year (short tons) of Carbon Dioxide (CO₂)
 - _____ Tons/year (short tons) of Nitrous Oxide (N₂O)
 - _____ Tons/year (short tons) of Perfluorocarbons (PFCs)
 - _____ Tons/year (short tons) of Sulfur Hexafluoride (SF₆)
 - _____ Tons/year (short tons) of Carbon Dioxide equivalent of Hydrofluorocarbons (HFCs)
 - _____ Tons/year (short tons) of Hazardous Air Pollutants (HAPs)

h. Will the proposed action generate or emit methane (including, but not limited to, sewage treatment plants, landfills, composting facilities)? Yes No

If Yes:

- i. Estimate methane generation in tons/year (metric): _____
- ii. Describe any methane capture, control or elimination measures included in project design (e.g., combustion to generate heat or electricity, flaring). _____

i. Will the proposed action result in the release of air pollutants from open-air operations or processes, such as quarry or landfill operations? Yes No

If Yes: Describe operations and nature of emissions (e.g., diesel exhaust, rock particulates/dust): _____

j. Will the proposed action result in a substantial increase in traffic above present levels or generate substantial new demand for transportation facilities or services? Yes No

If Yes:

- i. When is the peak traffic expected (Check all that apply): Morning Evening Weekend
 Randomly between hours of _____ to _____
- ii. For commercial activities only, projected number of truck trips/day and type (e.g., semi trailers and dump trucks). _____



It should be noted traffic will be decreased as a result of converting from business to 1 spt.

iii. Parking spaces: Existing Proposed _____ Net increase/decrease _____

iv. Does the proposed action include any shared use parking? Yes No

v. If the proposed action includes any modification of existing roads, creation of new roads or change in existing access, describe: _____

vi. Are public/private transportation service(s) or facilities available within 1/2 mile of the proposed site? Yes No

vii. Will the proposed action include access to public transportation or accommodations for use of hybrid, electric or other alternative fueled vehicles? Yes No

viii. Will the proposed action include plans for pedestrian or bicycle accommodations for connections to existing pedestrian or bicycle routes? Yes No

k. Will the proposed action (for commercial or industrial projects only) generate new or additional demand for energy? Yes No

If Yes:

i. Estimate annual electricity demand during operation of the proposed action: _____

ii. Anticipated sources/suppliers of electricity for the project (e.g., on site combustion, on site renewable, via grid/local utility, or other): _____

iii. Will the proposed action require a new, or an upgrade, to an existing substation? Yes No

l. Hours of operation. Answer all items which apply.

i. During Construction:

- Monday - Friday: _____
- Saturday: _____
- Sunday: N/A
- Holidays: _____

ii. During Operations:

- Monday - Friday: _____
- Saturday: _____
- Sunday: _____
- Holidays: _____

m. Will the proposed action produce noise that will exceed existing ambient noise levels during construction, operation, or both? Yes No
 If yes:
 i. Provide details including sources, time of day and duration.

ii. Will the proposed action remove existing natural barriers that could act as a noise barrier or screen? Yes No
 Describe: _____

n. Will the proposed action have outdoor lighting? Yes No
 If yes:
 i. Describe source(s), location(s), height of fixture(s), direction/aim, and proximity to nearest occupied structures:

ii. Will proposed action remove existing natural barriers that could act as a light barrier or screen? Yes No
 Describe: _____

o. Does the proposed action have the potential to produce odors for more than one hour per day? Yes No
 If Yes, describe possible sources, potential frequency and duration of odor emissions, and proximity to nearest occupied structures:

p. Will the proposed action include any bulk storage of petroleum (combined capacity of over 1,100 gallons) or chemical products 185 gallons in above ground storage or any amount in underground storage? Yes No
 If Yes:
 i. Product(s) to be stored _____
 ii. Volume(s) _____ per unit time _____ (e.g., month, year)
 iii. Generally, describe the proposed storage facilities: _____

q. Will the proposed action (commercial, industrial and recreational projects only) use pesticides (i.e., herbicides, insecticides) during construction or operation? Yes No
 If Yes:
 i. Describe proposed treatment(s):

ii. Will the proposed action use Integrated Pest Management Practices? Yes No

r. Will the proposed action (commercial or industrial projects only) involve or require the management or disposal of solid waste (excluding hazardous materials)? Yes No
 If Yes:
 i. Describe any solid waste(s) to be generated during construction or operation of the facility:
 • Construction: _____ tons per _____ (unit of time)
 • Operation: _____ tons per _____ (unit of time)
 ii. Describe any proposals for on-site minimization, recycling or reuse of materials to avoid disposal as solid waste:
 • Construction: _____
 • Operation: _____
 iii. Proposed disposal methods/facilities for solid waste generated on-site:
 • Construction: _____
 • Operation: _____

s. Does the proposed action include construction or modification of a solid waste management facility? Yes No

If Yes:

i. Type of management or handling of waste proposed for the site (e.g., recycling or transfer station, composting, landfill, or other disposal activities): _____

ii. Anticipated rate of disposal/processing:

- _____ Tons/month, if transfer or other non-combustion/thermal treatment, or
- _____ Tons/hour, if combustion or thermal treatment

iii. If landfill, anticipated site life: _____ years

t. Will the proposed action at the site involve the commercial generation, treatment, storage, or disposal of hazardous waste? Yes No

If Yes:

i. Name(s) of all hazardous wastes or constituents to be generated, handled or managed at facility: _____

ii. Generally describe processes or activities involving hazardous wastes or constituents: _____

iii. Specify amount to be handled or generated _____ tons/month

iv. Describe any proposals for on-site minimization, recycling or reuse of hazardous constituents: _____

v. Will any hazardous wastes be disposed at an existing offsite hazardous waste facility? Yes No

If Yes: provide name and location of facility: _____

If No: describe proposed management of any hazardous wastes which will not be sent to a hazardous waste facility: _____

E. Site and Setting of Proposed Action

E.1. Land uses on and surrounding the project site

a. Existing land uses.

i. Check all uses that occur on, adjoining and near the project site

- Urban Industrial Commercial Residential (suburban) Rural (non-farm)
- Forest Agriculture Aquatic Other (specify): _____

ii. If mix of uses, generally describe:

Proposal to convert a 1st floor office space to a 1 bedroom apartment

b. Land uses and covertypes on the project site.

Land use or Covertype	Current Acreage	Acreage After Project Completion	Change (Acres +/-)
• Roads, buildings, and other paved or impervious surfaces			
• Forested			
• Meadows, grasslands or brushlands (non-agricultural, including abandoned agricultural)			
• Agricultural (includes active orchards, field, greenhouse etc.)			
• Surface water features (lakes, ponds, streams, rivers, etc.)			
• Wetlands (freshwater or tidal)			
• Non-vegetated (bare rock, earth or fill)			
c. Other Describe: _____			

c. Is the project site presently used by members of the community for public recreation? Yes No
 i. If Yes: explain _____

d. Are there any facilities serving children, the elderly, people with disabilities (e.g., schools, hospitals, licensed day care centers, or group homes) within 1500 feet of the project site? Yes No
 If Yes,
 i. Identify Facilities: _____

e. Does the project site contain an existing dam? Yes No
 If Yes:
 i. Dimensions of the dam and impoundment:
 • Dam height: _____ feet
 • Dam length: _____ feet
 • Surface area: _____ acres
 • Volume impounded: _____ gallons OR acre-feet
 ii. Dam's existing hazard classification: _____
 iii. Provide date and summarize results of last inspection: _____

f. Has the project site ever been used as a municipal, commercial or industrial solid waste management facility, or does the project site adjoin property which is now, or was at one time, used as a solid waste management facility? Yes No
 If Yes:
 i. Has the facility been formally closed? Yes No
 • If yes, cite sources/documentation: _____
 ii. Describe the location of the project site relative to the boundaries of the solid waste management facility: _____
 iii. Describe any development constraints due to the prior solid waste activities: _____

g. Have hazardous wastes been generated, treated and/or disposed of at the site, or does the project site adjoin property which is now or was at one time used to commercially treat, store and/or dispose of hazardous waste? Yes No
 If Yes:
 i. Describe waste(s) handled and waste management activities, including approximate time when activities occurred: _____

h. Potential contamination history. Has there been a reported spill at the proposed project site, or have any remedial actions been conducted at or adjacent to the proposed site? Yes No
 If Yes:
 i. Is any portion of the site listed on the NYSDEC Spills Incidents database or Environmental Site Remediation database? Check all that apply: Yes No
 Yes - Spills Incidents database Provide DEC ID number(s): _____
 Yes - Environmental Site Remediation database Provide DEC ID number(s): _____
 Neither database
 ii. If site has been subject of RCRA corrective activities, describe control measures: _____
 iii. Is the project within 2000 feet of any site in the NYSDEC Environmental Site Remediation database? Yes No
 If yes, provide DEC ID number(s): _____
 iv. If yes to (i), (ii) or (iii) above, describe current status of site(s): _____

v. Is the project site subject to an institutional control limiting property uses? Yes No

- If yes, DEC site ID number: _____
- Describe the type of institutional control (e.g., deed restriction or easement): _____
- Describe any use limitations: _____
- Describe any engineering controls: _____
- Will the project affect the institutional or engineering controls in place? Yes No
- Explain: _____

E.2. Natural Resources On or Near Project Site

a. What is the average depth to bedrock on the project site? _____ feet

b. Are there bedrock outcroppings on the project site? Yes No
 If Yes, what proportion of the site is comprised of bedrock outcroppings? _____ %

c. Predominant soil type(s) present on project site: _____ %
 _____ %
 _____ %

d. What is the average depth to the water table on the project site? Average: _____ feet

e. Drainage status of project site soils: Well Drained: _____ % of site
 Moderately Well Drained: _____ % of site
 Poorly Drained: _____ % of site

f. Approximate proportion of proposed action site with slopes: 0-10%: _____ % of site
 10-15%: _____ % of site
 15% or greater: _____ % of site

g. Are there any unique geologic features on the project site? Yes No
 If Yes, describe: _____

h. Surface water features

i. Does any portion of the project site contain wetlands or other waterbodies (including streams, rivers, ponds or lakes)? Yes No

ii. Do any wetlands or other waterbodies adjoin the project site? Yes No
 If Yes to either i or ii, continue. If No, skip to E.2.i.

iii. Are any of the wetlands or waterbodies within or adjoining the project site regulated by any federal, state or local agency? Yes No

iv. For each identified regulated wetland and waterbody on the project site, provide the following information:

- Streams: Name _____ Classification _____
- Lakes or Ponds: Name _____ Classification _____
- Wetlands: Name _____ Approximate Size _____
- Wetland No. (if regulated by DEC) _____

v. Are any of the above water bodies listed in the most recent compilation of NYS water quality-impaired waterbodies? Yes No
 If yes, name of impaired water body/bodies and basis for listing as impaired: _____

i. Is the project site in a designated Floodway? Yes No

j. Is the project site in the 100-year Floodplain? Yes No

k. Is the project site in the 500-year Floodplain? Yes No

l. Is the project site located over, or immediately adjoining, a primary, principal or sole source aquifer? Yes No
 If Yes:

i. Name of aquifer: _____

m. Identify the predominant wildlife species that occupy or use the project site:

N/A

n. Does the project site contain a designated significant natural community?

Yes No

If Yes:

i. Describe the habitat/community (composition, function, and basis for designation):

ii. Source(s) of description or evaluation:

iii. Extent of community/habitat:

- Currently: _____ acres
- Following completion of project as proposed: _____ acres
- Gain or loss (indicate + or -): _____ acres

o. Does project site contain any species of plant or animal that is listed by the federal government or NYS as endangered or threatened, or does it contain any areas identified as habitat for an endangered or threatened species?

Yes No

If Yes:

i. Species and listing (endangered or threatened)

p. Does the project site contain any species of plant or animal that is listed by NYS as rare, or as a species of special concern?

Yes No

If Yes:

i. Species and listing:

q. Is the project site or adjoining area currently used for hunting, trapping, fishing or shell fishing? If yes, give a brief description of how the proposed action may affect that use:

Yes No

E.3. Designated Public Resources On or Near Project Site

a. Is the project site, or any portion of it, located in a designated agricultural district certified pursuant to Agriculture and Markets Law, Article 25-AA, Section 303 and 304?

Yes No

If Yes, provide county plus district name/number:

b. Are agricultural lands consisting of highly productive soils present?

Yes No

i. If Yes: acreage(s) on project site?

ii. Source(s) of soil rating(s):

c. Does the project site contain all or part of, or is it substantially contiguous to, a registered National Natural Landmark?

Yes No

If Yes:

i. Nature of the natural landmark: Biological Community Geological Feature

ii. Provide brief description of landmark, including values behind designation and approximate size/extent:

d. Is the project site located in or does it adjoin a state listed Critical Environmental Area?

Yes No

If Yes:

i. CEA name:

ii. Basis for designation:

iii. Designating agency and date:

e. Does the project site contain, or is it substantially contiguous to, a building, archaeological site, or district which is listed on the National or State Register of Historic Places, or that has been determined by the Commissioner of the NYS Office of Parks, Recreation and Historic Preservation to be eligible for listing on the State Register of Historic Places? Yes No

If Yes:

i. Nature of historic/archaeological resource: Archaeological Site Historic Building or District

ii. Name: _____

iii. Brief description of attributes on which listing is based: _____

f. Is the project site, or any portion of it, located in or adjacent to an area designated as sensitive for archaeological sites on the NY State Historic Preservation Office (SHPO) archaeological site inventory? Yes No

g. Have additional archaeological or historic site(s) or resources been identified on the project site? Yes No

If Yes:

i. Describe possible resource(s): _____

ii. Basis for identification: _____

h. Is the project site within five miles of any officially designated and publicly accessible federal, state, or local scenic or aesthetic resource? Yes No

If Yes:

i. Identify resource: _____

ii. Nature of, or basis for, designation (e.g., established highway overlook, state or local park, state historic trail or scenic byway, etc.): _____

iii. Distance between project and resource: _____ miles.

i. Is the project site located within a designated river corridor under the Wild, Scenic and Recreational Rivers Program 6 NYCRR 666? Yes No

If Yes:

i. Identify the name of the river and its designation: _____

ii. Is the activity consistent with development restrictions contained in 6NYCRR Part 666? Yes No

F. Additional Information

Attach any additional information which may be needed to clarify your project.

If you have identified any adverse impacts which could be associated with your proposal, please describe those impacts plus any measures which you propose to avoid or minimize them.

G. Verification

I certify that the information provided is true to the best of my knowledge

Applicant/Sponsor Name Gabe Girard Date 3-9-21

Signature [Handwritten Signature] Title Property Manager and husband of one of the owners.

62 Brinkerhoff

BRINKERHOFF STREET

59 Brinkerhoff

61 Brinkerhoff

63 Brinkerhoff

65 Brinkerhoff

2 Couch

4 Couch

6 Couch

8 Couch

10 Couch

12 Couch

Couch

8 Couch

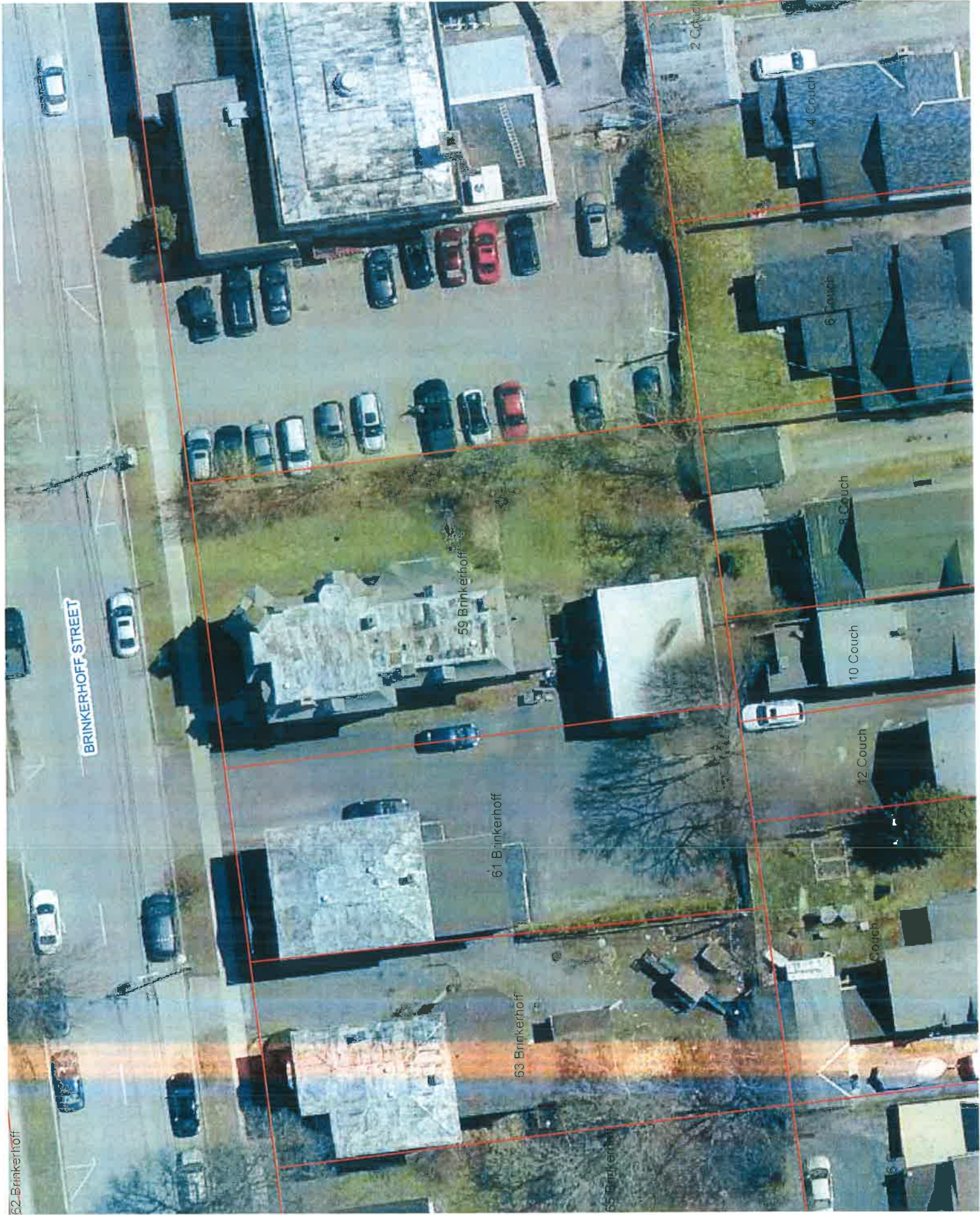



Image capture Nov 2015 © 2015 Google

Sburgh, New York

Google

1 View





St. John the Baptist Church
 St. Basil's Parish
 Catholic Church
 St. John the Baptist Church