



MACKENZIE ARCHITECTS P.C.

162 Battery Street, Burlington, Vermont 05401 802.863.7177 (T) www.mackenziearchitects.com

Plattsburgh Mixed Use Development
View from Bridge St. & Durkee St.

The City of Plattsburgh
Plattsburgh, NY
8/10/2020

1



MACKENZIE ARCHITECTS P.C.

162 Battery Street, Burlington, Vermont 05401 802.863.7177 (T) www.mackenziearchitects.com

Plattsburgh Mixed Use Development
View on Bridge St

The City of Plattsburgh
Plattsburgh, NY
8/10/2020



McFarland Johnson
 60 RAILROAD PLACE
 SUITE 402
 SARATOGA SPRINGS, NEW YORK 12866
 P:518-580-9380 F:518-580-9383
 mjnc.com

PROJECT MILESTONE
 SITE PLAN SUBMISSION

NO.	DATE	DESCRIPTION
▲	04/16/20	CITY COMMENTS
▲	05/05/20	CLARIFICATIONS
▲	05/11/20	ZBA COMMENTS
▲	05/21/20	ADDED DIMENSIONS
▲	06/05/20	ADDED SIGNAGE
▲	08/10/20	BUILDING REVISION
▲	08/10/20	BLDG USE REVISION

CLIENT: **PRIME PLATTSBURGH, LLC**
 CITY OF PLATTSBURGH, NEW YORK
 PROJECT: **DURKEE STREET MIXED USE DEVELOPMENT**

DRAWN	NSO
DESIGNED	NSO
CHECKED	TCB
SCALE	1"=20'
DATE	FEBRUARY 2020
PROJECT	18491.00

IT IS A VIOLATION OF LAW FOR ANY PERSON, UNLESS THEY ARE ACTING UNDER THE DIRECT DIRECTION OF A LICENSED PROFESSIONAL ENGINEER, ARCHITECT, LANDSCAPE ARCHITECT, OR LAND SURVEYOR, TO ALTER AN ITEM IN ANY WAY. IF AN ITEM BEARING THE STAMP OF A LICENSED PROFESSIONAL IS ALTERED, THE ALTERING ENGINEER, ARCHITECT, LANDSCAPE ARCHITECT, OR LAND SURVEYOR SHALL STAMP THE DOCUMENT AND INCLUDE THE NOTATION "ALTERED BY" FOLLOWED BY THEIR SIGNATURE, THE DATE OF SUCH ALTERATION, AND A SPECIFIC DESCRIPTION OF THE ALTERATION.

DRAWING TITLE

SITE PLAN

DRAWING NUMBER

C-01

05 OF 24



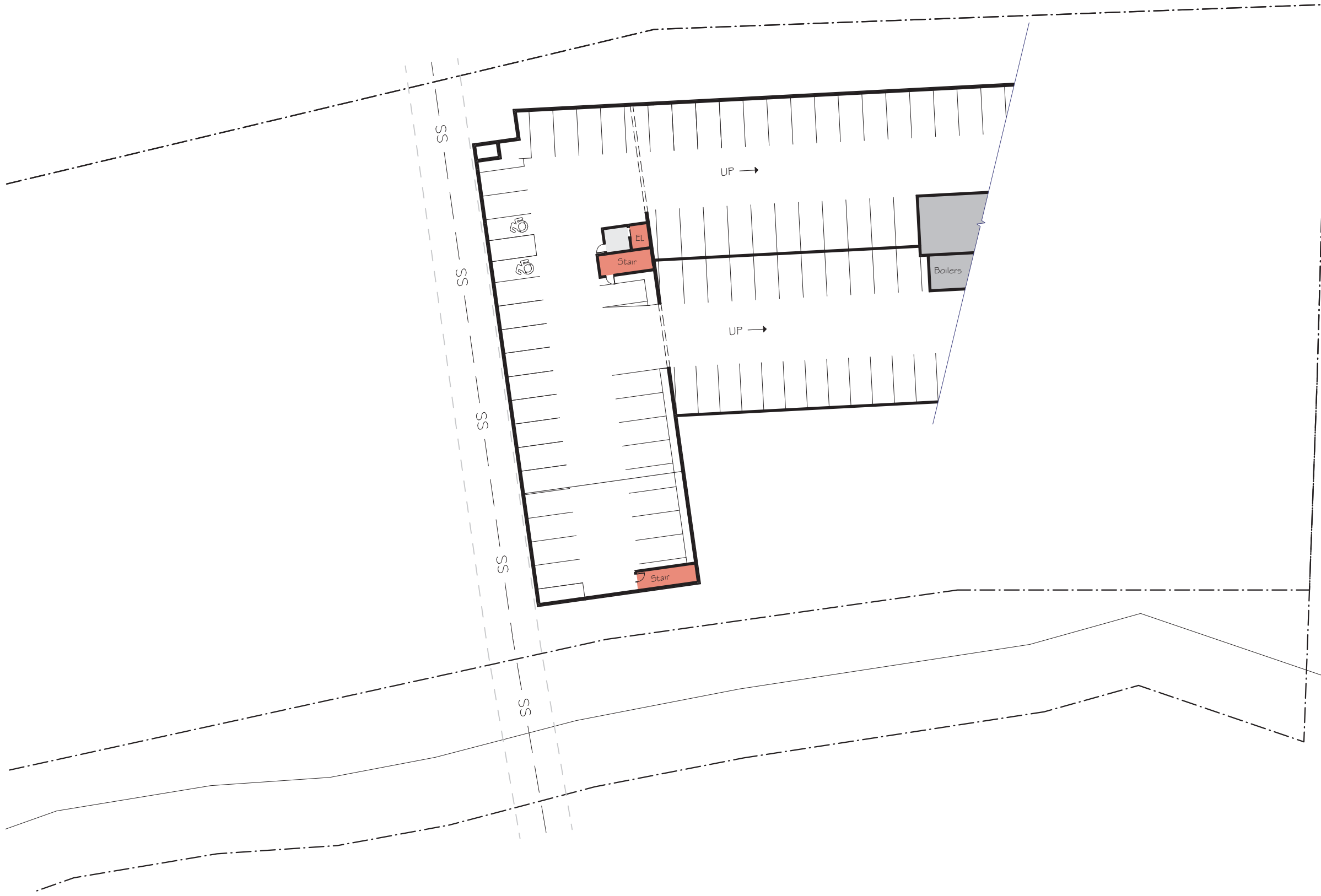

- Commercial
- Resident Amenities
- Support
- Roof Terraces
- Vertical Circulation
- One Bedroom
- Two Bedroom
- Three Bedroom
- Attic

SCALE AT 11"x17": 1" = 40'



MACKENZIE ARCHITECTS P.C.

162 Battery Street, Burlington, Vermont 05401 802.863.7177 (T) www.mackenziearchitects.com

Plattsburgh Mixed Use
Development
Sub Basement Plan

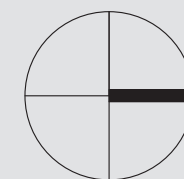

Project North

The City of Plattsburgh
Plattsburgh, NY
9/25/2020

A2.1

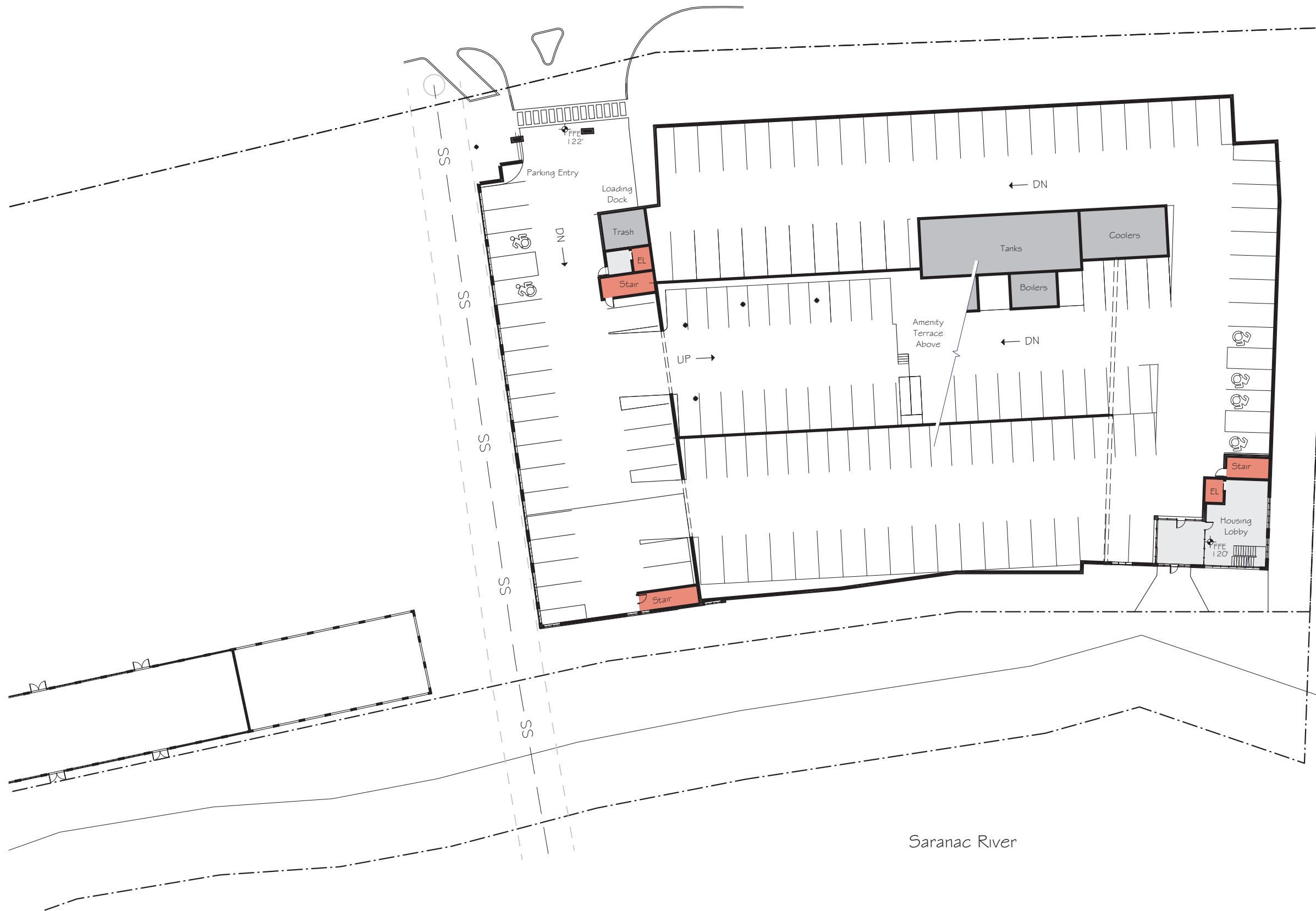

- Commercial
- Resident Amenities
- Support
- Roof Terraces
- Vertical Circulation
- One Bedroom
- Two Bedroom
- Three Bedroom
- Attic

SCALE AT 11"x17": 1" = 40'



MACKENZIE ARCHITECTS P.C.

162 Battery Street, Burlington, Vermont 05401 802.863.7177 (T) www.mackenziearchitects.com

**Plattsburgh Mixed Use
Development
Basement Plan**

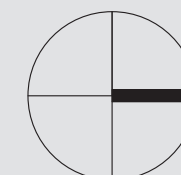

Project North

The City of Plattsburgh
Plattsburgh, NY
9/25/2020

A2.2



- Commercial
- Resident Amenities
- Support
- Roof Terraces
- Vertical Circulation
- One Bedroom
- Two Bedroom
- Three Bedroom
- Attic

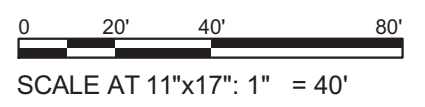

MACKENZIE ARCHITECTS P.C.

162 Battery Street, Burlington, Vermont 05401 802.863.7177 (T) www.mackenziearchitects.com

**Plattsburgh Mixed Use
Development
Level One Plan**

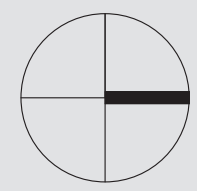

Project North

The City of Plattsburgh
Plattsburgh, NY
9/25/2020

A2.3

Ownership of Instruments of Service: All reports, drawings, specifications, computer files, field data, notes and other documents and instruments prepared by the Mackenzie Architects as instruments of service shall remain the property of the Mackenzie Architects. Mackenzie Architects shall retain all common law, statutory and other reserved rights, including the copyright thereto.



- Commercial
- Resident Amenities
- Support
- Roof Terraces
- Vertical Circulation
- One Bedroom
- Two Bedroom
- Three Bedroom
- Attic

SCALE AT 11"x17": 1" = 40'



MACKENZIE ARCHITECTS P.C.

162 Battery Street, Burlington, Vermont 05401 802.863.7177 (T) www.mackenziearchitects.com

Plattsburgh Mixed Use
Development
Level Two & Three Plan

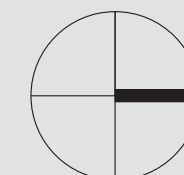

Project North

The City of Plattsburgh
Plattsburgh, NY
9/25/2020

A2.4



- Commercial
- Resident Amenities
- Support
- Roof Terraces
- Vertical Circulation
- One Bedroom
- Two Bedroom
- Three Bedroom
- Attic

SCALE AT 11"x17": 1" = 40'



MACKENZIE ARCHITECTS P.C.

162 Battery Street, Burlington, Vermont 05401 802.863.7177 (T) www.mackenziearchitects.com

Plattsburgh Mixed Use
Development
Level Four Plan

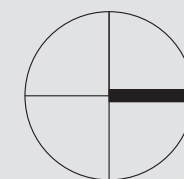

Project North

The City of Plattsburgh
Plattsburgh, NY
9/25/2020

A2.5



- Commercial
- Resident Amenities
- Support
- Roof Terraces
- Vertical Circulation
- One Bedroom
- Two Bedroom
- Three Bedroom
- Attic

SCALE AT 11"x17": 1" = 40'



MACKENZIE ARCHITECTS P.C.

162 Battery Street, Burlington, Vermont 05401 802.863.7177 (T) www.mackenziearchitects.com

Plattsburgh Mixed Use
Development
Mezzanine Plan

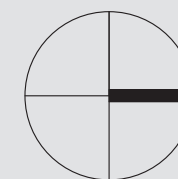

Project North

The City of Plattsburgh
Plattsburgh, NY
9/25/2020

A2.6



1
A5.1

WEST ELEVATION

SCALE @ 11X17: 1"=20'

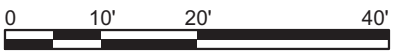

MACKENZIE ARCHITECTS P.C.
 162 Battery Street, Burlington, Vermont 05401 802.863.7177 (T) www.mackenziearchitects.com

Plattsburgh Mixed Use Development
 Building Elevations

The City of Plattsburgh
 Plattsburgh, NY
 9/25/2020

Ownership of Instruments of Service: All reports, drawings, specifications, computer files, field data, notes and other documents and instruments prepared by the Mackenzie Architects as instruments of service shall remain the property of the Mackenzie Architects. Mackenzie Architects shall retain all common law, statutory and other reserved rights, including the copyright thereto.



1
A5.2

SOUTH ELEVATION

SCALE @ 11X17: 1"=20'

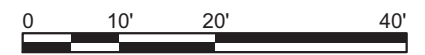

MACKENZIE ARCHITECTS P.C.
 162 Battery Street, Burlington, Vermont 05401 802.863.7177 (T) www.mackenziearchitects.com

Plattsburgh Mixed Use Development
 Building Elevations

The City of Plattsburgh
 Plattsburgh, NY
 9/25/2020

A5.2

Ownership of Instruments of Service: All reports, drawings, specifications, computer files, field data, notes and other documents and instruments prepared by the Mackenzie Architects as instruments of service shall remain the property of the Mackenzie Architects. Mackenzie Architects shall retain all common law, statutory and other reserved rights, including the copyright thereto.



1
A5.3

NORTH ELEVATION

SCALE @ 11X17: 1"=20'

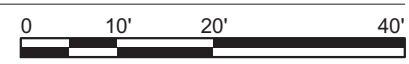

MACKENZIE ARCHITECTS P.C.

162 Battery Street, Burlington, Vermont 05401 802.863.7177 (T) www.mackenziearchitects.com

Plattsburgh Mixed Use Development
Building Elevations

The City of Plattsburgh
Plattsburgh, NY
9/25/2020



1
A5.4

EAST ELEVATION

SCALE @ 11X17: 1"=20'



MACKENZIE ARCHITECTS P.C.

162 Battery Street, Burlington, Vermont 05401 802.863.7177 (T) www.mackenziearchitects.com

Plattsburgh Mixed Use Development
Building Elevations

The City of Plattsburgh
Plattsburgh, NY
9/25/2020

A5.4